

YOUR NAME \_\_\_\_\_

Start the trail at the black arrow  
Follow the numbers from 1-14

**1 PORCH**

On the wall is a plaque about the building of the Church. When was the first service?

\_\_\_\_\_

Who was the architect?

\_\_\_\_\_

S \_\_\_\_\_ S \_\_\_\_\_

**2 COAT OF ARMS**

As you enter the Church look behind you over the door. There is the Royal Coat of Arms of King James I. Which creatures can you see on the sides?

\_\_\_\_\_

**3 FONT**



At the back of the Church is a font. How many sides does it have?

\_\_\_\_\_

The font is used for Baptism (Christening). What is poured into the font?

\_\_\_\_\_

EAST

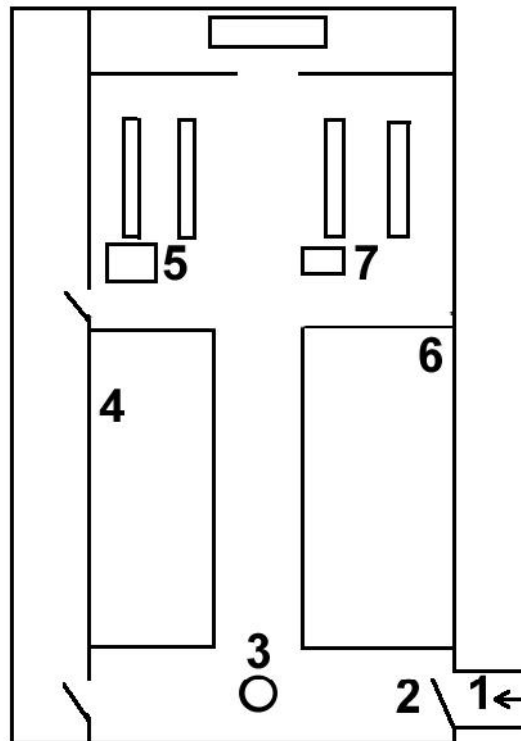

**4 STAINED GLASS**

Look for the window showing Miriam.



What musical instrument is she holding?

\_\_\_\_\_

Who is the window in memory of?

\_\_\_\_\_

**5 PULPIT**

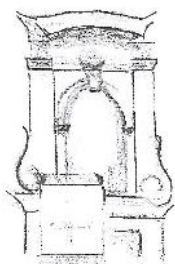

Who would usually use the pulpit?

\_\_\_\_\_

Why do you think it is up high?

\_\_\_\_\_

WEST

**6 HATCHMENTS**

Near the top of the walls are diamond shaped boards called hatchments. Find the one with the winged dragon. Draw a dragon or copy the words on the hatchment.



**7 LECTERN**

What is on the lectern (reading desk)?

\_\_\_\_\_

There is a small plaque on the side showing the name of the person it is in memory of. Who is it?

\_\_\_\_\_

**8 COMMUNION TABLE**

The communion table is in the east end of the Church. This is the most important part of the Church.



Why do people kneel at the rails in front of the table?

---



---

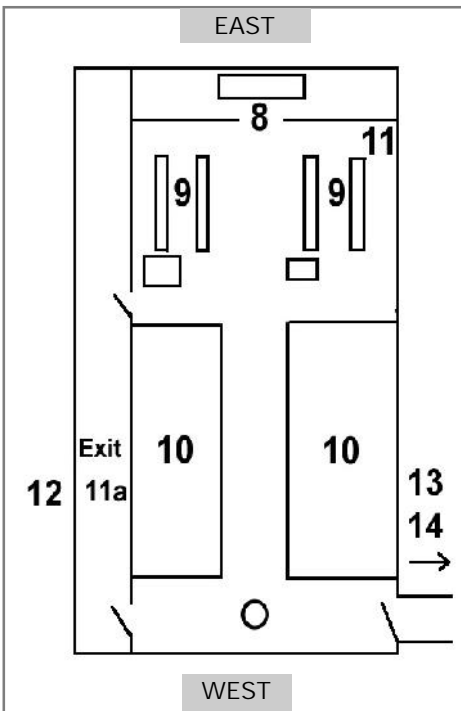

**9 CHANCEL**

Near the communion table are some pews (seats) that face one another.



Who are they for?

---



---

**10 PEWS**

In the pews are kneelers (hassocks).

Draw a picture of what you would put on a kneeler.

**11 BANNER**

Look at the banner showing scenes of Theydon Bois.

Draw your banner about Epping Forest — you will see another banner in the lobby to the Parish Centre (11a).

**PLEASE WAIT FOR AN ADULT BEFORE GOING OUTSIDE TO ANSWER THE FOLLOWING 3 QUESTIONS**

**12 CHURCHYARD**

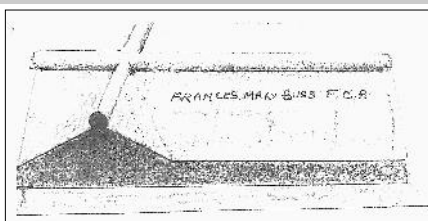

Which school was started by Frances Mary Buss?

---

**13 WAR MEMORIAL**



Did more people die in the First or the Second World War?

---

**14 CHURCHYARD**

What is at the top of the weather vane on the spire?

Draw your own weather vane

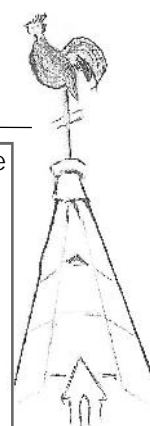

---

**ENDPIECE**

WELL DONE! You have now finished the Church Trail. We hope you have enjoyed finding out about St Mary's. Please write what you liked most about it and then sit a little while and think about all the people who have come here in the past 150 years.

---



Welcome to St Mary's, a very beautiful little church and churchyard which plays an important part in the life of the village of Theydon Bois.



### 1 PORCH

There are two plaques describing the different churches and telling us that the previous church was not solid enough and had to be replaced. The first service in this church was held on 9 February 1851. Sydney Smirke was the architect. He also designed the Reading Room at the British Museum.

### 2 COAT OF ARMS



The Lion and the Unicorn are the creatures on the Coat of Arms and still today they can be seen on a Royal Coat of Arms. Some people think that the lion's face looks like the face in the lower central part which is a portrait of King James I. Perhaps the artist thought the King wanted to be seen as being as strong as a lion?

### 3 FONT

The font is a large bowl used for Baptism (Christening) to welcome people into the family of the Church. Water for Baptism is put in the font. Baptism of a baby or an older person happens when the water is put on their head, because water is a symbol of cleanliness and purity. The font has 8 sides; it is an octagon.

### 4 STAINED GLASS

The musical instrument that Miriam is holding is a tambourine.  
The window is in memory of Miriam of Clyst House, Theydon Bois.

### 5 PULPIT

The pulpit would usually be used by the priest or the preacher who gives a sermon (talk) during a service. The pulpit is raised so that the speaker can be seen and heard easily.

### 6 HATCHMENTS



HONOR VIRTUTIS PRAEMIUM (Latin). In English: HONOUR IS THE REWARD OF VIRTUE.

Hatchments like these are rare. They show the full armorial bearings of some local families, as well as the one with King James I's Coat of Arms.

### 7 LECTERN

The lectern is a large bookstand which holds the Holy Bible or other book from which religious extracts are read.

This lectern was presented to the church in memory of Charles A Church.

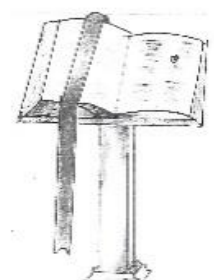

## 8 COMMUNION TABLE

During a service people coming to the communion table are encouraged to kneel as a mark of humility when the priest gives them the Sacraments (bread and wine) or a blessing.

## 9 CHANCEL

The chancel contains the pews where members of the choir sit. Originally this part of the church was reserved for the clergy and choir and was often divided from the rest of the church by a rood screen or steps.

## 10 PEWS

The hassocks have been made by members of the church congregation.



## 11 BANNER

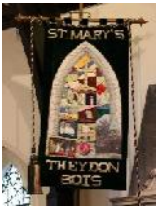

We live in the beautiful area of Epping Forest which has so many different trees, plants, wildlife and ponds for everyone to enjoy. St Mary's is in the Forest.  
The banner was made for the Millennium.

## 12 CHURCHYARD

Miss Frances Mary Buss was the founder of the North London Collegiate School and worked tirelessly to further teacher training and to encourage science and art in education. She also founded the Camden School for Girls.

Miss Buss is buried in the churchyard on the north side of the church with her cousin and his wife, who lived nearby.



## 13 WAR MEMORIAL

More people from the area died in the First World War.

Around the memorial among the plants are some rosemary bushes. In the language of flowers, rosemary is for remembrance, so both the memorial and the rosemary show that we remember the people named. Rub a little rosemary between your fingers, it smells lovely.

## 14 CHURCHYARD

At the top of the spire is a cockerel on a cross. Many churches have such a cockerel to remind us of an important part of the story of Jesus. Three times the disciple Peter denied knowing Jesus, and each time the cock crowed.

## ENDPIECE

We hope you have enjoyed helping the children with this trail. If you would like to find out more about St Mary's please visit [theydonparishes.org](http://theydonparishes.org).

## PRAYER

Dear God

Thank you for this church of St Mary's in Theydon Bois

In it, we find lots to learn and to think about

You understand good and bad times, and are older than anything we can see

Help us and all who come here to know that you hear the prayers we make in this special place

Amen

---