



YOUR NAME _____ Start the trail at the grey arrow
Follow the numbers from 1-14

1 FONT
Mark the Font on the church plan.
How many sides does the Font have?

In the box, draw the design on one of the sides of the Font.

2 PARISH MAP
Look at the old map of Holsworthy Parish on the wall to the left of the Baptistry window.
Who drew this map?
C H C _ _ _ _ _
Two of the surrounding parishes begin with **C**.
Write their names below.
C _ _ _ _ _
C _ _ _ _ _

3 LIST OF PRIESTS
When did Henri de Halleswordi become the priest in this church?
1 _ _ _
Who was appointed as priest here in 1701?
D _ _ _ _ _
S _ _ _ _ _

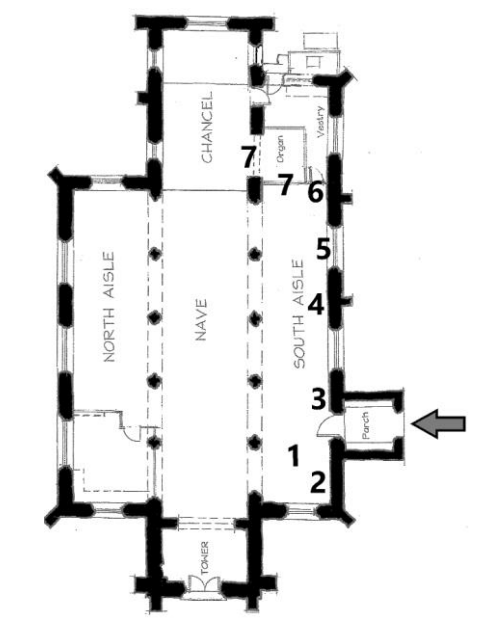

4 MEMORIAL
Look at the monument tablets either side of the Notice Board.
On the right:
Francis Cole
was a
C _ _ _ _ _ **AND**
DRUGGIST OF THIS TOWN
and on the left:
Francis Thorne
was an
I _ _ _ _ _
OF THIS TOWN

5 WINDOW
Find this stained glass panel.



Who is shown above it in the centre panel?
J _ _ _ _
Who sponsored the restoration of this window?
HOLSWORTHY
F _ _ _ _ _
Which year? _ _ _ _ **AD**

6 MEMORIAL
There is a very old gravestone on the wall to the left of the window.
What is the date on it?
1 _ _ _
There is a shield in the middle of the stone. Draw what you see in the shield.

7 ORGAN
Look carefully at the organ pipes in the Chancel and the South aisle. What are the colours of these pipes?
South Aisle: **G** _ _ _ _
Chancel: **G** _ _ _ _
How many pipes are there above the organ console in the Chancel?

Where is the longest of these pipes?
in the **m** _ _ _ _ _

8 ALTAR

What is the colour of the cloth on the front of the altar?

Look at the reredos (the wooden carved and painted screen behind the altar). St Peter is on the far left. What is he holding?

K _ _ _

and **F** _ _ _

St Paul is on the far right. What is he holding as well as a paper scroll?

S _ _ _ _

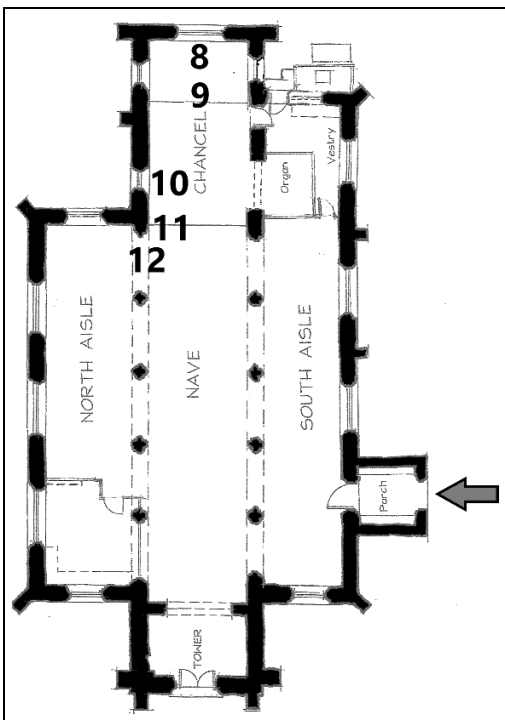

9 CHANCEL ROOF

Stand by the Altar rail and look up.

The angels are standing on the corbels (stone brackets supporting the roof timbers). How many angels are there on the corbels?

There are beautifully carved and painted bosses where the roof timbers meet. How many gold bosses are there?

10 PELICAN WINDOW

Look at the stained glass window above the Choir Stalls opposite the organ. Right at the top is a pelican sitting on a nest. How many chicks are there?

In the bottom of the window, there is a memorial to Samuel and Eliza Fry. Who was Eliza's father?

R _ _ _ _ **K** _ _ _ _ _ **MA**

How long was he the Rector of this parish?

_ _ years

11 PRAYING HANDS

On the pillar by the pulpit, there is a carving of praying hands.

What is the first word of the label?

P _ _ _ _ _

brings hope

When were the hands carved?

_ _ _ _ _



12 PULPIT

Who uses the pulpit?

The **P** _ _ _ _ _

There is a carved border round each of the panels. What is the fruit in these borders?

G _ _ _ _ _

At the bottom there is a brass memorial to:

John A _ _ _ _ _

1883 - _ _ _ _

13 PASCHAL CANDLE

Somewhere in the church there is a big candle with a design on it on a tall wooden stand. Look round the church to find it.

Draw a circle on the plan of the church to mark the position of the candle.

In the box, draw a picture of the design on the candle.

14 STATIONS OF THE CROSS

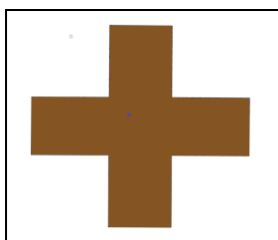

There are little crosses like this on the church walls. They all have a number written in Roman Numerals on them.

How many crosses are there?

On the diagram on the left, draw the number you see on the cross on the right side of the organ in the Chancel.